



**Talking AM/FM Clock Radio
with Built-In Nightlight**

OWNER'S MANUAL

DTE810

Copyright 2004 Viacom International Inc. All Rights Reserved. Nickelodeon, Dora the Explorer and all related titles, logos and characters are trademarks of Viacom International Inc.

SAFETY PRECAUTIONS



CAUTION

**RISK OF ELECTRIC SHOCK
DO NOT OPEN**



CAUTION: TO REDUCE THE RISK OF ELECTRIC SHOCK, DO NOT REMOVE COVER (OR BACK). NO USER-SERVICEABLE PARTS INSIDE. REFER SERVICING TO QUALIFIED SERVICE PERSONNEL.

- TO PREVENT FIRE OR SHOCK HAZARD. DO NOT EXPOSE THIS APPLIANCE TO RAIN OR MOISTURE.
- TO PREVENT ELECTRICAL SHOCK, MATCH WIDE BLADE PLUG TO WIDE SLOT, FULLY INSERT.



DANGEROUS VOLTAGE

Uninsulated Dangerous Voltage, that may be of sufficient magnitude to constitute a risk of electric shock to persons is present within this product's enclosure.



ATTENTION

The Owner's Manual contains important operating and maintenance instructions. For your safety, it is necessary to refer to the manual.

CAUTION: ELECTRICALLY OPERATED PRODUCT:

Not recommended for children under 8 years of age. As with all electric products, precautions should be observed during handling and use to prevent electric shock.

INFORMATION

This equipment has been tested and found to comply with the limits for a Class B digital device, pursuant to Part 15 of the FCC Rules. These limits are designed to provide reasonable protection against harmful interference in a residential installation. If this equipment does cause harmful interference to radio or television reception, which can be determined by turning the equipment off and on, the user is encouraged to try to correct the interference by one or more of the following measures:

- Reorient or relocate the receiving antenna.
- Increase the separation between the equipment and receiver.
- Connect the equipment into an outlet on a circuit different from that to which the receiver is connected.
- Consult the dealer or an experienced radio/TV technician for help.

SAFETY PRECAUTIONS

1. Read these instructions.
2. Keep these instructions.
3. Heed all warnings.
4. Follow all instructions.
5. Do not use this apparatus near water.
6. Clean only with dry cloth.
7. Do not block any ventilation openings. Install in accordance with the manufacturer's instructions.
8. Do not install near any heat sources such as radiators, heat registers, stoves or other apparatus (including amplifiers) that produce heat.
9. Do not defeat the safety purpose of the polarized or grounding-type plug. A polarized plug has two blades with one wider than the other. A grounding-type plug has two blades and a third grounding prong. The wide blade or the third prong are provided for your safety. If the provided plug does not fit into your outlet, consult an electrician for replacement of the obsolete outlet.
10. Protect the power cord from being walked on or pinched particularly at plugs, convenience receptacles, and the point where they exit from the apparatus.
11. Only use attachments / accessories specified by the manufacturer.
12. Unplug this apparatus during lightning storms or when unused for long periods of time.
13. Refer all servicing to qualified service personnel. Servicing is required when the apparatus has been damaged in any way, such as power-supply cord or plug is damaged, liquid has been spilled or objects have fallen into the apparatus, the apparatus has been exposed to rain or moisture, does not operate normally, has changed its performance, or has been dropped.
14. This appliance shall not be exposed to dripping or splashing water and that no object filled with liquids such as vases shall be placed on the apparatus.
15. Do not overload wall outlet. Use only power source as indicated.
16. Use replacement parts as specified by the manufacturer.
17. The product may be mounted to a wall only if recommended by the manufacturer.
18. Upon completion of any service or repairs to this product, ask the service technician to perform safety checks.

Emerson Radio Corp. has produced this audio product under license from Nickelodeon. We have taken great care to make sure your unit was in perfect working order when it left our factory.

It has been designed to give you many years of enjoyment and trouble-free operation. Read this manual before operating this unit to become familiar with its features. In the event you require technical assistance, please contact the Emerson Radio Customer Service hotline at 1-800-898-9020. Retain this manual for future reference.

NOTES:

- Please avoid using this unit in places of high temperature or humidity over prolonged periods of time as damage may occur.
- Exposure to direct sunlight in places such as car interiors may cause the unit to become warped and/or lead to malfunctioning.
- Avoid using or storing this unit in dusty or sandy locations.
- The product should be periodically examined for conditions that may result in the risk of fire, electric shock, or injury to persons and that, in an event such conditions, the product should not be used until properly repaired.

For future reference, record the serial number in the space provided.

Model No: DTE810

Serial Number _____

LOCATION OF CONTROLS

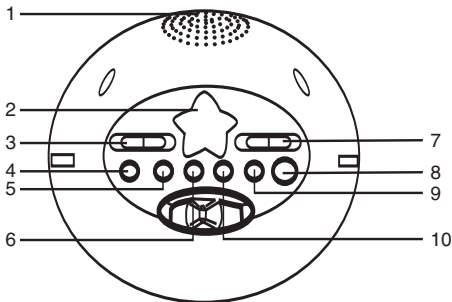

1. Speaker
2. Night Light
3. Function Switch (OFF/ON/AUTO/DORA)
4. SLEEP Button
5. ALARM Button
6. TIME Button
7. BAND Switch (FM/AM)
8. DORA Button
9. MINUTE Button
10. HOUR Button
11. Snooze Button
12. VOLUME Control
13. AM Indicator
14. LIGHT Switch
15. ALARM ON Indicator
16. TUNING Control
17. Display
18. AC Cord

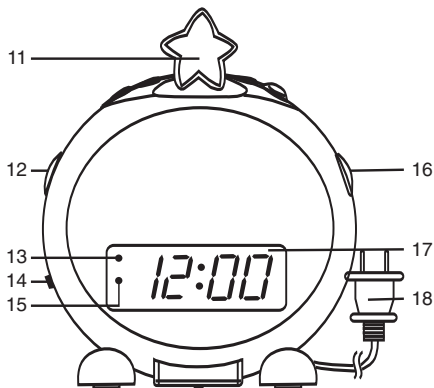

INSTALLATION

Unravel the AC cord and connect it to a conveniently located AC outlet having 120V and 60Hz only. The Clock Display will illuminate and a flashing time will appear in the window. The Clock Display will continue to flash until the time has been set.

CAUTION: To prevent electric shock, match wide blade of plug to wide slot, fully insert.

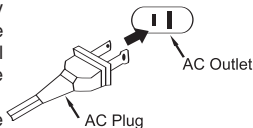

If the AC cord is disconnected or if there is a power failure, this electronic clock is designed to continue operating internally (without showing the time on the Clock Display) with a 9 volt battery (not included). To install the battery, open the battery compartment by pressing in the tab and lifting off the door. Connect the battery to the terminals of the battery snap inside the compartment (use of an alkaline battery is recommended) and slide the battery compartment cover into place.

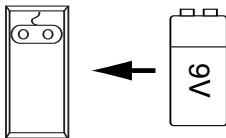

Be sure to check the condition of the battery periodically by disconnecting the AC cord and connecting it again 2 or 3 minutes later. The preset times should continue operating. If a flashing time appears on the Clock Display, it indicates the battery is dead or not connected properly. The 9 volt battery will keep the internal time accurately for approximately 30 minutes. If the power is restored after 30 minutes, the time may need to be reset.

- | | |
|---|--|
| <ul style="list-style-type: none">• Replacement of batteries must be done by an Adult.• Do not mix old and new batteries.• Do not mix alkaline, standard (carbon-zinc) or rechargeable (nickel-cadmium) batteries.• Do not use rechargeable batteries.• The supply terminals are not to be short-circuited. | <ul style="list-style-type: none">• Non-rechargeable batteries are not to be recharged.• Exhausted batteries are to be removed.• Only batteries of the equivalent type are to be used.• Batteries are to be inserted with the correct polarity. |
|---|--|

WARNING:

Choking Hazard - - Small Parts and Packing Materials
Not for children under 8 years.

- * All materials for fastening or packing purchases are not part of the unit and should be discarded for children's safety.
- * Please keep all information for future reference.
- * This is not a toy.



REMOVE THE TRY ME BATTERY BOX

An adult should remove the enclosed Try Me Battery Box as it is not required for daily use. Please dispose of button batteries in accordance with local regulations, Do Not incinerate. Please install the back-up battery as indicated inside the battery compartment.

NOTE: Button cell battery pack is included for try me purposes only.

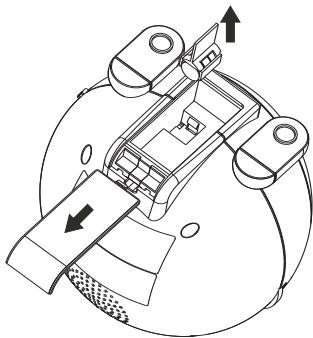

OPERATION

TO PLAY THE RADIO

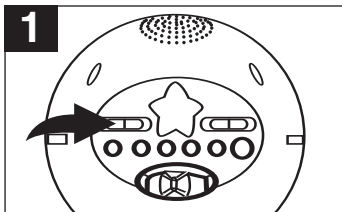

Slide the Function switch to the ON position.

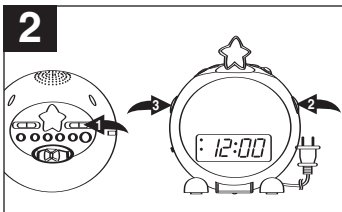

Slide the BAND switch ① to the desired band (AM or FM) and tune a station by turning the TUNING control ②. Adjust the VOLUME control ③ as desired.

Antennas

FM: Extend and rotate the AC Cord for better FM reception.

AM: Turn the unit for better AM reception.

TO SET OR RESET THE ACTUAL TIME

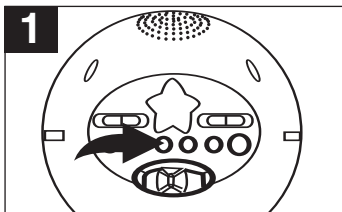

Press and hold the TIME button.

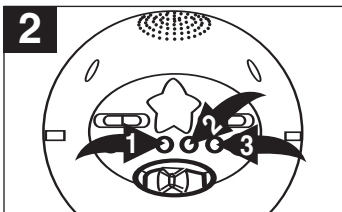

While holding the TIME button ①, press the HOUR ② and MINUTE ③ buttons to advance the time until the desired time is shown on the display. Make sure the AM indicator is lit if the time is AM and not lit if the time is PM.

OPERATION (CONTINUED)

TO SET OR RESET THE ALARM TIME

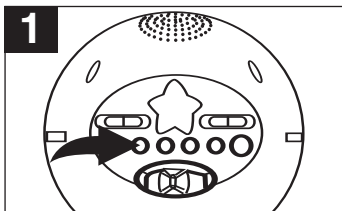

Press and hold the ALARM button.

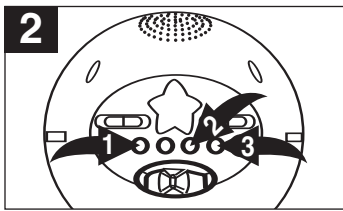

While holding the ALARM button ❶, press the HOUR ❷ and MINUTE ❸ buttons to advance the time until the desired alarm time is shown on the display. Make sure the AM indicator is lit if the time is AM and not lit if the time is PM.

TO SET THE ALARM TO WAKE TO RADIO

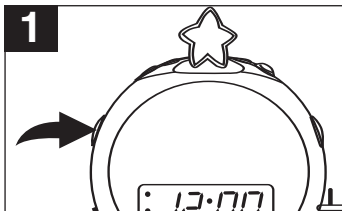

Set the alarm time as previously instructed. Select a radio station and make sure the VOLUME control is set as desired.

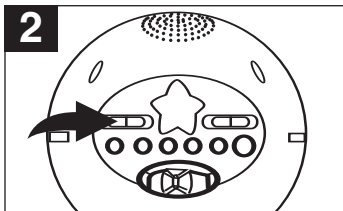

Slide the Function switch to the AUTO position. When the actual time matches the selected preset alarm time, the radio automatically turns on for one hour and then shuts off.

Note: See next page to shut off the alarm and for the Snooze feature.

OPERATION (CONTINUED)

TO SET THE ALARM TO WAKE TO DORA

1

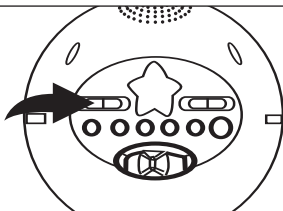

Set the alarm time as previously instructed. Slide the Function switch to the DORA position. When the actual time matches the selected preset alarm time, the Dora phrase will automatically sound for one hour and then shut off.

DORA PHRASE BUTTON

Press the DORA button repeatedly in any mode to hear Dora Phrases.

TO SHUT ALARM OFF

1

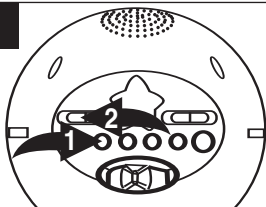

To shut off the alarm, press the ALARM button ❶ once and the alarm time will be reset for the next day. Slide the Function switch ❷ to the OFF position to turn off the alarm and not set it for the next day.

SNOOZE FUNCTION

1

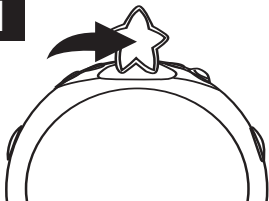

The alarm can be temporarily turned off manually by pressing the SNOOZE button; the radio or Dora Phrases will turn back on automatically nine minutes later.

OPERATION (CONTINUED)

TO ACTIVATE THE SLEEP FUNCTION

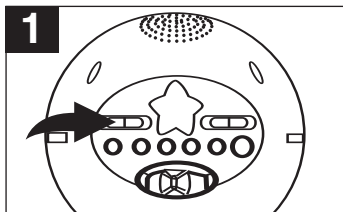

Tune the desired radio station as previously instructed and slide the Function switch to the AUTO position.

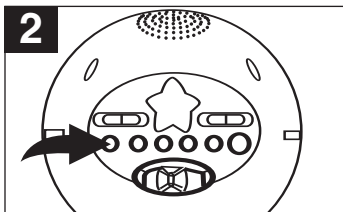

Press the SLEEP button, 0:59 will appear on the clock display and the radio will come on, then release the button.

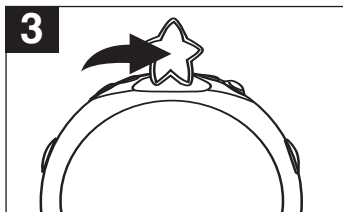

To cancel sleep time before it counts down to "00" and turn the radio off, press the SNOOZE button.

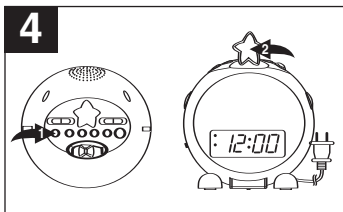

If you press the SLEEP button ❶ again after setting the sleep time, the sleep time will be set to 59 minutes automatically. To turn off the sleep time, press the SNOOZE button ❷.

NOTE:

To select a longer playing time up to a maximum of 1 hour and 59 minutes, press the SLEEP and HOUR buttons simultaneously (the display will show 1 hour and 59 minutes). To adjust the minutes, press and hold the SLEEP button and press the MINUTE button until the desired time is shown on the clock display. Release the button when the preferred time is shown in the display.

OPERATION (CONTINUED)

TO ACTIVATE THE NIGHT LIGHT

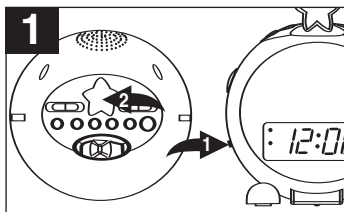

Slide the NIGHT LIGHT switch ❶ to the ON position to turn the night light ❷ on.

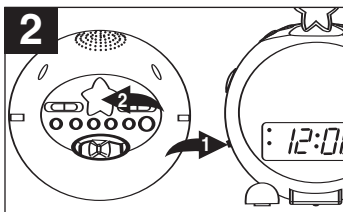

Slide the NIGHT LIGHT switch ❶ to the OFF position to turn the night light ❷ off.

NOTE: The long life LEDs inside the Night Light should last for the life of the clock radio; they are not user replaceable.

TROUBLESHOOTING GUIDE

SYMPTOM	POSSIBLE CAUSE	POSSIBLE SOLUTION
GENERAL		
Power does not come on.	AC line cord not plugged in.	Insert plug firmly into AC outlet.
RADIO		
No sound.	Function switch is not set to ON position.	Set Function switch to ON position.
	VOLUME control at minimum position.	Turn the VOLUME control up.
Noise or sound distorted on AM or FM.	AM—Interference from traffic.	Turn the radio for better AM reception.
	FM—AC Cord not extended.	Extend AC Cord.
Radio does not turn off with SLEEP feature.	Function switch is not in AUTO position.	Set Function switch to the AUTO position.
CLOCK		
Flashing time.	Battery connected improperly, not connected or dead.	Check the battery.
	Clock not set.	Set the clock.
Alarm does not turn on.	Function switch is not in AUTO or DORA position.	Set Function switch to the AUTO or DORA position.
	Clock not set.	Set the clock.
	Alarm time not set.	Set alarm time.

**EMERSON RADIO CORP.
LIMITED WARRANTY**

Emerson Radio Corp. warrants manufacturing defects in original material, including original parts and workmanship, under normal use and conditions, for a period of ninety (90) days from the date of original purchase in the U.S. With your dated proof of purchase, we will provide repair service at no charge for labor and parts at an authorized Depot Repair Facility, or replace the product at our discretion. For repair or replacement, pack your unit in a padded box, enclose your check or money order payable to Emerson Radio Corp. in the amount of \$9.00 (not required by California residents) to cover shipping and handling costs, and enclose a copy of your proof of purchase. Send your unit to:

Emerson Radio Corp.,
5101 Statesman Drive,
Irving, TX 75063.

This warranty does not cover damage from negligence, misuse, abuse, accident, failure to follow operating instructions, commercial use, rental, repairs by an unauthorized facility, or products purchased, used, serviced or damaged outside of the United States.

THIS WARRANTY GIVES YOU SPECIFIC LEGAL RIGHTS, AND YOU MAY ALSO HAVE OTHER RIGHTS WHICH VARY FROM STATE TO STATE.

AU898M



Emerson

AUTHORIZED SERVICE

TO FIND THE LOCATION AND
PHONE NUMBER OF YOUR
NEAREST AUTHORIZED
SERVICE CENTER...

CALL TOLL FREE: 1-800-695-0098

FOR ADDITIONAL SET-UP OR OPERATING ASSISTANCE
PLEASE CALL:
1-800-898-9020

FOR CUSTOMER SERVICE, PLEASE WRITE TO:
Emerson Radio Corp.
Consumer Affairs Dept.
5101 Statesman Drive,
Irving, TX 75063.



EMERSON
PART NO: 21-2067
608-05

Printed in China